



# *Bella Coola Emergency Response Plan*



## **ANNEX A – General Evacuation Plan**

*Central Coast Regional District*

*Updated by Frontier Resource Management Ltd  
January, 2018*

# Annex A – General Evacuation Plan

## Table of Contents

<i>Evacuation Plan Overview</i>	<u>4</u>
<b>1 Introduction</b>	<b>5</b>
1.1 Situations Warranting Evacuation	5
1.2 Legal Authority	6
1.2.1 First Nation Reserve Lands	6
1.3 Evacuation Assumptions	6
<b>2 Initiating Evacuations</b>	<b>7</b>
2.1 Notifying People at Risk	7
2.2 Stage 1 – Evacuation Alert	7
2.3 Stage 2 – Evacuation Order	8
2.3.1 RCMP Instructions	9
2.4 Stage 3 – Evacuation Rescinded	9
2.5 Local Evacuation Levels	10
<b>3 Roles and Responsibilities</b>	<b>10</b>
3.1 Evacuation Checklist	11
3.2 Neighbourhood Emergency Units	11
<b>4 General Evacuation Strategy</b>	<b>14</b>
4.1 Safe Area Options	15
4.2 Special Provisions	16
4.3 Transport	16
4.4 Travel Passes	16
4.5 Accommodation & Feeding	17
4.6 Access Traffic Control	17
4.7 Securing Property	18
4.8 Tracking Evacuees	18
<b>5 Livestock Evacuation</b>	<b>18</b>
5.1 General Livestock Evacuation Plan	18
5.2 Special Provisions	19
5.3 Transport	19
5.4 Accommodation & Feeding	19
<b>6 Shelter In Place Option</b>	<b>20</b>

6.1	Shelter In Place Instructions	20
7	<i>Appendices</i>	20
7.1	Public Information Messaging Template	21
7.2	Evacuation Alert Template	22
7.3	Evacuation Order Template	23
7.4	Evacuation Rescind Template	24
7.5	Evacuation Plan Checklist	25
7.6	Evacuation Access and Travel Permits	29
7.7	Evacuation Operations Guidelines (EMBC, 2009)	32

# Evacuation Plan Overview

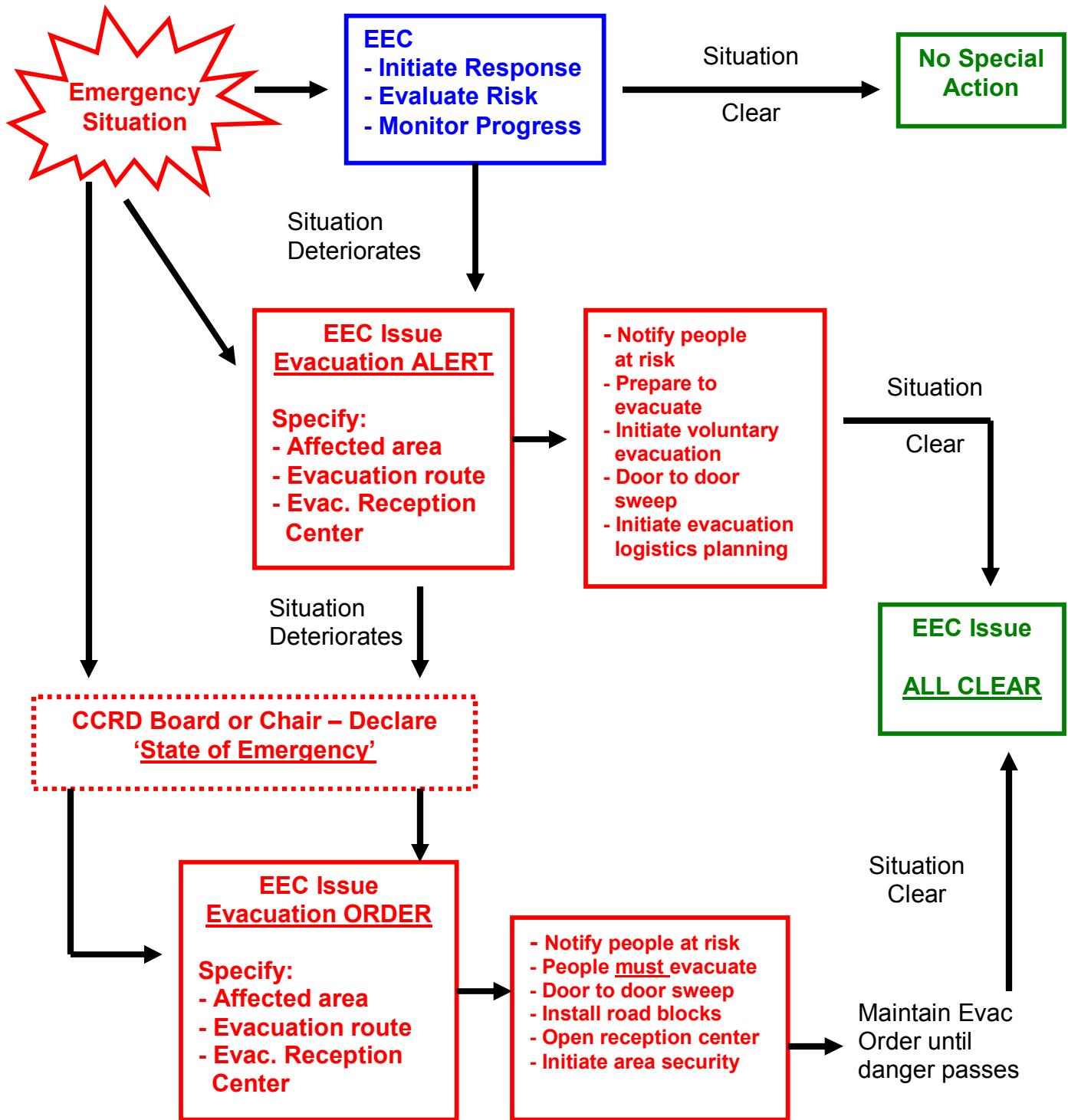

# 1 Introduction

The General Evacuation Plan is intended to be the broad evacuation strategy for the valley. It is to be used in conjunction with the specific hazard Emergency Response Plans which provide further evacuation information in relation to the specific emergency.

The evacuation system followed in this plan is consistent with the Provincial evacuation system. Further evacuation information is contained in the “Evacuation Operational Guidelines” (2009) contained in CCRD EMP Annex D EMBC Supporting Emergency Manuals.

Evacuation planning deals with the ‘population at risk’ and the ‘host population’ that will help take care of the people at risk of harm. The key challenges that Bella Coola faces in implementing a safe and orderly evacuation are:

- Limited evacuation route options
- Limited safe zones to evacuate to
- Limited mass transit abilities
- Livestock transport
- Isolation

## 1.1 Situations Warranting Evacuation

The situations that could warrant evacuation in the Bella Coola valley are likely to be:

- Fire – wildland and urban interface
- Flood
- Tsunami
- Threat of landslide, avalanche or debris flow
- Harmful material spill
- Threat of explosion

Evacuations may be small and localized or they may affect the whole valley.

**A first order of business in an emergency is to notify the CCRD so that, if necessary, a State of Emergency can be declared without delay to initiate evacuations.**

It should also be noted that in some cases, it may be safer for people to take shelter in their homes (transport to a place of refuge may be more hazardous than staying put).

## **1.2 Legal Authority**

The legal authority to order evacuations rests within the *Emergency Program Act*, which empowers the Chair of the CCRD, or designate, to declare a 'state of local emergency' which gives the legal power to evacuate persons and livestock. In addition, there are legal provincial statutes that empower other authorities to order evacuations.

- Local Authority (CCRD Board or Chair)
- Minister responsible for Emergency Program Act (if Provincial State of Emergency has been declared)
- BC Fire Commissioner
- Ministry responsible for Health
- Ministry responsible for Forests, Lands Natural Resource Operations and Rural Development
- Ministry responsible for the Environment
- Ministry responsible for Energy, Mines and Resources

### **1.2.1 First Nation Reserve Lands**

Provincial legislation does not apply to reserve lands, so CCRD can not issue evacuation orders over First Nation reserves. The *Indian Act* empowers the First Nation band to make by-laws to protect the health and safety of residents and therefore can issue evacuation orders. Federal and Provincial governments encourage joint evacuation alerts with neighbouring regional districts. First Nations are also encouraged to draft band council resolutions for evacuations prior to an emergency event and signed by Chief and Council.

## **1.3 Evacuation Assumptions**

During evacuation situations there are a number of common responses from those involved and this plan is based on the following EMBC assumptions:

- People will spontaneously evacuate when there is sufficient warning of threat.
- 5-20% of people at risk will evacuate before being told to do so.
- Some will refuse to evacuate regardless of threat.
- Some will refuse to evacuate unless arrangements have been made for their animals.
- 10-20 % of population will require assistance in reception centres or group lodgings.
- Many will seek shelter with relatives, friends or hotels without need of government help.
- For some hazards, like flooding or tsunamis, standard evacuation routes will be used.

## 2 Initiating Evacuations

For the CCRD, the decision to initiate evacuations will come through the EOC command or Emergency Coordinator. Other Provincial authorities may also initiate evacuations through their own protocols.

### 2.1 *Notifying People at Risk*

To notify people at risk, first prepare the public information notice. See Appendix 1 for template. Then issue notice using the following means of communication:

- a. Mass email to all persons and organizations on emergency contact list – EEC, Inter-Agency Emergency Management Council, NE Region EMBC, etc
- b. If emergency situation is localized to a small part of valley, initiate phone call out to those residents at risk.
- c. If broad part of valley is affected, initiate SD 49 'phone call out tree'
- d. Request emergency notice transmission by CBC, Nuxalk Radio and Hagensborg TV Society to Bella Coola residents
- e. Post notice to Bella Coola Facebook page (also send to Coast Mountain news for posting on their page).
- f. For high risk areas, consider deploying qualified crews to go door to door.
- g. Utilize VHF channel LAD 1 to transmit notice.
- h. For marine based emergency, issue notice via Marine 6 transmission.

As the emergency unfolds, additional warnings/directions may need to be provided on an ongoing basis using the means above. See also ANNEX A – Communication Plan.

### 2.2 *Stage 1 – Evacuation Alert*

The purpose of an Evacuation Alert is to inform the population at risk of potential or impending danger. An Alert:

- highlights the nature of the danger and that people should be prepared to evacuate the area.
- Encourages the population at risk to begin a voluntary, orderly leave of the affected area, within a specified time frame.
- Warns that the situation may require immediate action with very short notice.

- Priorizes the movement of populations with special needs such as elderly, handicapped or transient populations including tourists and schools.

An “Evacuation Alert” template is provided on Appendix 2.

**A ‘State of Local Emergency Declaration’ is not necessary to issue and Evacuation Alert.**

In some cases, there may be no time to issue an Alert and an Evacuation Order may be issued immediately. In these cases, evacuation will be done on an *ad hoc* basis as directed by the Incident Commander at the scene with support from EOC.

### **2.3 Stage 2 – Evacuation Order**

The order to evacuate all or part of an area should only be given after careful consideration of all the factors involved, with life and safety being paramount.

**Prior to issuing an Evacuation Order, a State of Local Emergency must be declared.** See CCRD EMP Annex B – Declaring a State of Local Emergency.

Under an Evacuation Order:

- The population at risk is ordered to evacuate the area specified in a formal written order.
- All persons in the affected area are to be told that, in the interest of their own safety and considering the risk, they are now **ORDERED** to leave the area.
- An **ORDER** must be consistent and clear with no room for interpretive discretion on the part of the population at risk. They must leave the area immediately.
- The RCMP will enforce the Evacuation Order. Although people can not be forced from their homes, the RCMP may apprehend minors whose guardians refuse to obey the order. They may arrest individuals that obstruct the evacuation process or hinder the efforts of responders in performing their duties.
- The EOC is responsible to plan evacuation routes if pre-designated routes and plans do not apply.



- Removing people from their homes and livelihoods must not be taken lightly. People will already be under duress during an emergency; however, public safety must be first.
- A statement must be included in all bulletins, pamphlets, warnings and orders that makes it very clear to all that, while the evacuation order is in effect, the area in question will have controlled access and that a pass may be required to regain access to the area.
- Persons who remain in an area in violation of an Evacuation Order should be advised that they can not expect assistance if their lives are subsequently threatened by the hazard.

An Evacuation Order template is contained in Appendix 3

### **2.3.1 RCMP Instructions**

The RCMP will enforce the Evacuation Order in the following manner:

- Minors at risk, if their guardians are refusing to obey the evacuation order, will be apprehended and turned over to appropriate child protection agency.
- Individuals who are obstructing the evacuation process or hindering responders will be arrested and charged.

Discretion will be applied in apprehending or arresting as this process will take officers away from performing evacuation duties.

### **2.4 Stage 3 – Evacuation Rescinded**

When the emergency is over and the hazard area is declared safe, the Evacuation Order is to be rescinded and the population at risk is allowed to return to the area previously evacuated.

- If there is still the possibility that the danger may re-manifest itself then the Evacuation Alert or Evacuation Order might need to be reissued.
- It may be prudent to rescind the Evacuation Order accompanied with an Evacuation Alert.
- If a portion of the hazard area is determined to be safe, it is advisable that the Evacuation Order be rescinded in entirety but immediately followed by a new Evacuation Order for the area

still affected.

A sample Evacuation Rescind template is contained in Appendix 4

## 2.5 Local Evacuation Levels

Four different evacuation levels can be anticipated in Bella Coola:

**Level 1** – Small and localized, one to a few households.

**Level 2** – Neighbourhood evacuation, 5-25 households.

**Level 3** – Multi-neighbourhood and/or one of main population centres (Bella Coola, 4 Mile Reserve, Hagensborg, Salloompt, Smith Subdivision).

**Level 4** – Major part or the whole valley.

It is anticipated that the local community can handle Level 1 & 2 evacuations, but would require outside assistance in terms of transportation and reception centers for Level 3 & 4 evacuations.

## 3 Roles and Responsibilities

The RCMP normally has the overall responsibility for evacuation operations. The EOC will plan the evacuation and the EOC Director/Incident Commander will usually implement the evacuation. ESS Officer is responsible for the opening of the Reception Centre and/or group lodgings.

The following organizations are additional resources that can assist with evacuations.

Organization	Roles and Responsibilities
<b>Fire Departments</b>	<ul style="list-style-type: none"><li>• Door to door sweeps</li><li>• Rescue of stranded people</li></ul>
<b>Rangers</b>	<ul style="list-style-type: none"><li>• Door to door sweeps</li><li>• Rescue of stranded people</li></ul>
<b>Highways/Interior Roads</b>	<ul style="list-style-type: none"><li>• Assist with road blocks</li></ul>
<b>DFO/Snootli Hatchery</b>	<ul style="list-style-type: none"><li>• Rescue of stranded people, particularly flood and tsunami.</li></ul>
<b>Neighbourhood Emergency Teams</b>	<ul style="list-style-type: none"><li>• Notification of neighbours</li><li>• Door to door sweeps</li><li>• Rescue of stranded people</li><li>• Assist people with special transport needs</li></ul>

	<ul style="list-style-type: none"> <li>Assist with livestock</li> </ul>
<b>Ambulance</b>	<ul style="list-style-type: none"> <li>Transport of invalid people or those with special needs.</li> </ul>
<b>SAR</b>	<ul style="list-style-type: none"> <li>Notification to populations at risk</li> <li>Door to door sweep</li> </ul>
<b>Nuxalk Coastal Guardian Watchmen</b>	<ul style="list-style-type: none"> <li>Notification to populations at risk</li> <li>Door</li> </ul>
<b>School District Busses</b>	<ul style="list-style-type: none"> <li>Transport of large number of people.</li> </ul>
<b>BC Transit Bus</b>	<ul style="list-style-type: none"> <li>Transport of large number of people.</li> </ul>
<b>Pacific Coastal Bus</b>	<ul style="list-style-type: none"> <li>Transport of large number of people.</li> </ul>
<b>Nuxalk School &amp; College</b>	<ul style="list-style-type: none"> <li>Busses, vans</li> <li>Reception centres</li> </ul>
<b>Nuxalk Dev Corp</b>	<ul style="list-style-type: none"> <li>Bus</li> </ul>
<b>Tweedsmuir Lodge</b>	<ul style="list-style-type: none"> <li>Vans and bus</li> </ul>
<b>School District</b>	<ul style="list-style-type: none"> <li>Open schools for reception centres.</li> </ul>
<b>Valley Ridge Riders</b>	<ul style="list-style-type: none"> <li>Assist with transport of livestock.</li> </ul>
<b>Dogtown</b>	<ul style="list-style-type: none"> <li>Assist with pet evacuation</li> </ul>

### 3.1 Evacuation Checklist

Evacuation Planning Worksheet, checklists and instructions are contained in Appendix 5.

### 3.2 Neighbourhood Emergency Units

To facilitate orderly emergency planning and response, the Bella Coola valley has been broken up into Neighbourhood Emergency Units based on geography, hazard similarities and access characteristics. These Units also facilitate the identification of the Neighbourhood Emergency Teams (NET) that is the foundation of the local neighbourhood emergency program. The following table identifies the Units and provides basic descriptions of each.

ID #	Unit Name	Description	Estimated Population (Day/night)	Important Facilities Infrastructure	Key Hazards	Evac Routes
1	<b>Harbour</b>	Boat Harbour & shoreline buildings	50/10 season dependant	<ul style="list-style-type: none"> <li>Boats</li> <li>Fuel tanks</li> <li>Docks</li> <li>Ferry ramp</li> <li>Ice plant</li> <li>Hydro plant</li> </ul>	<ul style="list-style-type: none"> <li>Tsunami</li> <li>Fuel spills</li> <li>Explosions</li> <li>Avalanche</li> <li>Ammonia</li> </ul>	<ul style="list-style-type: none"> <li>Sea</li> <li>North Bentinck FSR</li> <li>Hwy 20 east.</li> </ul>
2	<b>Bella Coola</b>	Town site	800/500	<ul style="list-style-type: none"> <li>Homes</li> <li>Businesses</li> <li>Hospital</li> <li>School</li> <li>RCMP</li> <li>Credit union</li> </ul>	<ul style="list-style-type: none"> <li>Tsunami</li> <li>River/ creek flood</li> <li>Power outage</li> <li>Storms</li> </ul>	<ul style="list-style-type: none"> <li>Hwy 20 east</li> <li>Harbour</li> <li>North Bentinck FSR</li> </ul>

ID #	Unit Name	Description	Estimated Population (Day/night)	Important Facilities Infrastructure	Key Hazards	Evac Routes
				<ul style="list-style-type: none"> <li>- Old age home</li> <li>- Nuxalk Hall</li> <li>- Moose Hall</li> <li>- General stores</li> <li>- Gas station</li> <li>- Gov't offices</li> <li>- Motels</li> <li>- Restaurants</li> <li>- Churches</li> <li>- Post office</li> </ul>	<ul style="list-style-type: none"> <li>- Hazardous material spill</li> <li>- Civil disobedience/ Violence acts</li> </ul>	<ul style="list-style-type: none"> <li>- Dirt road behind DFO office</li> </ul>
3	<b>4 Mile Reserve</b>	Reserve	400/500	<ul style="list-style-type: none"> <li>- Homes</li> <li>- Band administration</li> <li>- School</li> <li>- Gas station</li> <li>- Cemetery</li> <li>- BC Hydro generators</li> </ul>	<ul style="list-style-type: none"> <li>- Flooding</li> <li>- Fire</li> <li>- Power outage</li> <li>- Storms</li> <li>- Landslide</li> </ul>	<ul style="list-style-type: none"> <li>- Hwy 20 West to Bella Coola or Harbour</li> <li>- Hwy 20 east.</li> <li>- River in case of fire</li> </ul>
4	<b>Snooka</b>	Thorsen Ck to Stiles Road	50/90	<ul style="list-style-type: none"> <li>- Homes</li> <li>- Hwy bridges</li> <li>- livestock</li> <li>- Lobelco Hall</li> <li>- Fall fair grounds</li> <li>- Boat launch</li> <li>- SDA school</li> </ul>	<ul style="list-style-type: none"> <li>- Flood</li> <li>- Fire</li> <li>- Debris flow</li> <li>- Power outage</li> <li>- Storms</li> </ul>	<ul style="list-style-type: none"> <li>- Hwy 20 east &amp; west</li> <li>- River in case of fire.</li> <li>- Thorsen FSR.</li> </ul>
5	<b>Snootli Stretch</b>	Stiles road to Snootli ck, including Walker isln	75/75	<ul style="list-style-type: none"> <li>- Homes</li> <li>- Hwy bridges</li> <li>- Snootli hatchery</li> <li>- School bus depot</li> <li>- rec facilities</li> <li>- Rodeo grounds</li> <li>- Livestock</li> </ul>	<ul style="list-style-type: none"> <li>- Fire</li> <li>- Flood</li> <li>- Avalanche</li> <li>- Power outage</li> <li>- Storms</li> </ul>	<ul style="list-style-type: none"> <li>- Hwy 20 east or west</li> <li>- River in case of fire</li> </ul>
6	<b>Snootli/ Klonic</b>	Snootli ck to Klonic ck	60/75	<ul style="list-style-type: none"> <li>- Homes</li> <li>- Hwy bridges</li> <li>- Airport</li> <li>- Jet fuel</li> <li>- Church</li> <li>- Livestock</li> <li>- Llamas</li> <li>- Cemetery</li> <li>- Gov't offices</li> </ul>	<ul style="list-style-type: none"> <li>- Fire</li> <li>- Flood</li> <li>- Power outage</li> <li>- Storms</li> <li>- District water intake</li> </ul>	<ul style="list-style-type: none"> <li>- Hwy 20 east or west</li> <li>- Airport</li> <li>- River in case of fire</li> </ul>
7	<b>Hagensborg</b>	Klonic to Tippi's corner	500/400	<ul style="list-style-type: none"> <li>- Homes</li> <li>- General stores</li> <li>- Hotel</li> <li>- Restaurant</li> <li>- Businesses</li> <li>- Camp sites</li> <li>- School</li> <li>- Telephone</li> </ul>	<ul style="list-style-type: none"> <li>- Fire</li> <li>- Flood</li> <li>- Power outage</li> <li>- Storms</li> <li>- Act of violence</li> </ul>	<ul style="list-style-type: none"> <li>- Hwy 20 east or west</li> <li>- River in case of fire</li> </ul>

ID #	Unit Name	Description	Estimated Population (Day/night)	Important Facilities Infrastructure	Key Hazards	Evac Routes
				<ul style="list-style-type: none"> <li>relay center</li> <li>- Livestock</li> <li>- Church</li> <li>- Legion hall</li> <li>- Post office</li> <li>- Pool</li> </ul>		
8	<b>Salloompt Turnoff</b>	Tippies corner to Douglas Dr. including Salloompt road to bridge	60/80	<ul style="list-style-type: none"> <li>- Homes</li> <li>- Totem sawmill</li> <li>- Camp site</li> <li>- Boat launch</li> </ul>	<ul style="list-style-type: none"> <li>- Fire</li> <li>- Flood</li> <li>- Power outage</li> <li>- Storms</li> </ul>	<ul style="list-style-type: none"> <li>- Hwy 20 east or west</li> <li>- Salloompt FSR</li> <li>- River in case of fire</li> </ul>
9	<b>Salloompt</b>	North side of river	70/90	<ul style="list-style-type: none"> <li>- Homes</li> <li>- Livestock</li> <li>- Small business</li> </ul>	<ul style="list-style-type: none"> <li>- Fire</li> <li>- Flood</li> <li>- Power outage</li> <li>- Storms</li> </ul>	<ul style="list-style-type: none"> <li>- Hwy 20 east or west.</li> <li>- Salloompt FSR</li> <li>- River in case of fire</li> </ul>
10	<b>Smith Subdivision</b>	Douglas Dr to Nusatsum bridge	100/150	<ul style="list-style-type: none"> <li>- Homes</li> <li>- Interior Roads shop</li> <li>- Church</li> <li>- Livestock</li> <li>- Hwy bridge</li> <li>- Gravel pit</li> <li>- Feed store</li> </ul>	<ul style="list-style-type: none"> <li>- Fire</li> <li>- Flood</li> <li>- Power outage</li> <li>- Storms</li> </ul>	<ul style="list-style-type: none"> <li>- Hwy 20 east or west</li> <li>- West Nusatsum FSR</li> <li>- River in case of fire</li> </ul>
11	<b>East Nusatsum</b>	Nusatsum bridge east to blue roof house	50/75	<ul style="list-style-type: none"> <li>- Homes</li> <li>- Livestock</li> <li>- Sawmill</li> <li>- MoT gravel pit</li> <li>- BC Redi Mix gravel pit</li> </ul>	<ul style="list-style-type: none"> <li>- Fire</li> <li>- Flood</li> <li>- Power outage</li> <li>- Storms</li> </ul>	<ul style="list-style-type: none"> <li>- Hwy 20 east or west</li> <li>- East Nusatsum FSR</li> <li>- River in case of fire</li> </ul>
12	<b>Glacier View</b>	Blue roof house east to Canoe crossing	40/60	<ul style="list-style-type: none"> <li>- Homes</li> <li>- Livestock</li> <li>- Hwy bridges</li> <li>- Motel</li> <li>- Camp site</li> <li>- Gravel pit</li> <li>- Boat launch</li> </ul>	<ul style="list-style-type: none"> <li>- Fire</li> <li>- Flood</li> <li>- Power outage</li> <li>- Storms</li> </ul>	<ul style="list-style-type: none"> <li>Hwy 20 east or west</li> <li>-Noosgulch FSR</li> <li>- River in case of fire</li> </ul>
13	<b>Firvale</b>	Canoe crossing to Firvale	20/30	<ul style="list-style-type: none"> <li>- Homes</li> <li>- Livestock</li> </ul>	<ul style="list-style-type: none"> <li>- Fire</li> <li>- Flood</li> <li>- Power outage</li> <li>- Storms</li> </ul>	<ul style="list-style-type: none"> <li>- Hwy 20 east or west</li> <li>- River in case of fire</li> </ul>
14	<b>Upper Firvale</b>	Firvale to Burnt	20/30	<ul style="list-style-type: none"> <li>- Homes</li> <li>- Livestock</li> </ul>	<ul style="list-style-type: none"> <li>- Fire</li> <li>- Flood</li> </ul>	<ul style="list-style-type: none"> <li>- Hwy 20 east or</li> </ul>

ID #	Unit Name	Description	Estimated Population (Day/night)	Important Facilities Infrastructure	Key Hazards	Evac Routes
		Bridge		- Hwy bridges	- Power outage - Storms	west - River in case of fire
15	<b>Tweedsmuir Park</b>	Burnt bridge to bottom of hill.	200/50 Seasonal	- Homes - Lodge - Telephone relay station - Hwy bridges - DFO salmon ground - Livestock - Park HQ - Camp grounds - Boat launch	- Fire - Flood - Power outage - Storms	- Hwy 20 east or west - River in case of fire - Talchacko FSR

## 4 General Evacuation Strategy

The population of the Bella Coola valley is 2,005 (2016 Canada Census). The majority of this population resides on the Bella Coola town site, 4 Mile Reserve, Hagensborg and Smith sub-division. The remaining population is scattered throughout the valley up to Stuie in Tweedsmuir Park with smaller concentrations of people in the Salloompt and Firvale areas. Most people east of Thorsen creek possess their own vehicular transportation while a fair number of people on the Bella Coola town site and 4 Mile Reserve do not have their own modes of transportation and will require assistance to evacuate.

There are only two practical routes in or out of the Bella Coola valley – by vehicle, east along Highway 20 or by boat, west by North Bentinck Arm. Evacuation along Hwy 20 is anticipated to be relatively quick given the few intersections and relatively small population. The worst traffic jams can be expected to occur at Bella Coola townsite and 4 Mile Reserve. Air transport out of the valley is logistically difficult and likely only in the most extreme situations.

In the valley itself there are a few logging roads that provide escape routes up the side valleys. However, they are dead end roads and people using these routes can become stranded if the front of these valleys are affected by an emergency. Given these considerations, the following general evacuation strategy is recommended:

- 1) Where possible, the preferred option is for people to use Hwy 20 and depending on scale of incident, people may evacuate to safe areas in the valley or in extreme cases east out of the

valley.

- 2) If evacuation to the east is not possible, people should use Hwy 20 and move to Bella Coola and if necessary, the harbour for evacuation by boat.
- 3) Secondary option is to evacuate by vehicle up the logging roads accessing the side valleys but this is only for desperate situations as people may get stranded. People should congregate in open areas for spotting and heli rescue.
  - North Bentinck FSR (past the harbour)
  - Clayton Falls FSR
  - Salloompt FSR
  - Nusatsum FSR,
  - Noosgulch FSR
- 4) Tertiary options for higher ground evacuations are:
  - Dirt road by DFO office in Bella Coola
  - Thorsen creek logging road
  - Glacier Creek (Cachootin)
  - Talchacko
- 5) For extreme situations, the following last chance options are recommended:
  - Flooding** – Head to base of mountains and walk up hill.
  - Fire** - Head to Bella Coola river and find wide gravel bar

#### **4.1 Safe Area Options**

Depending on the type of emergency and scale of situation, the following are potential Safe Area options:

- Hwy 20 – Harbour parking lot
  - Co-op parking lot
  - Acwsalcta school
  - Fall Fair grounds
  - SDA school grounds
  - Rodeo grounds
  - SAMS school
  - Interior Roads Shop site
  - Glacier View
  - Floyd Mechams Field
  - Stui

- Anahime Lake School

Clayton Falls Forest Road – Tsunami refuge for people at Harbour

By boat: - Bella Bella  
- Shearwater  
- Port Hardy

Other routes: - High and dry for flood  
- Near water body for fire  
- Open areas for spotting by air  
- Open areas for helicopter evacuation.

## **4.2 Special Provisions**

Populations needing assistance to evacuate are:

- Hospital – ambulatory patients
- Old age home – may need van or bus
- Bella Coola Elementary - bus
- Acwsalcta school – bus
- SDA school – bus
- NEA/SAMS school – bus
- House bound invalids – ambulance, van.

## **4.3 Transport**

Transportation options are limited in the valley:

- Busses: BC Transit, Nuxalk Dev Corp, Pacific Coastal, Tweedsmuir Lodge
- School busses – SD 49, Acwsalcta,
- BC Ambulances – 2 (3-4 patients)
- Emergency Transport Vehicle – Community Forest
- Vans: Tweedsmuir Lodge, Nuxalk College
- Discovery Coast Ferry
- Various crew boats and fishing boats

## **4.4 Travel Passes**

For prolonged evacuations, it may be necessary to set up system to allow people to travel through the danger area on a controlled basis. This could be by piloted convoy at specific time intervals or use of permits, limiting people to move through evacuated area for a specified time period and number of passengers. Sample pass is contained in Appendix 6.



#### **4.5 Accommodation & Feeding**

It is anticipated that the valley can accommodate and feed Level 1 and 2 evacuations without too much difficulty. However, outside resources would be required for Level 3 and 4 evacuations. Potential mass accommodation and feeding areas are:

- Bella Coola Elementary
- Nuxalk Hall
- Acswaltca School
- Lobelco Hall
- Canadian Legion
- SAMS Gym

Emergency Social Services will assist with identifying available accommodation services. See ESS Plan in Annex D for list of potential Reception Centres.

#### **4.6 Access Traffic Control**

Access control points need to be established for areas ordered to evacuate. This keeps people from re-entering the area and establishes a security barrier. Traffic control points can be established at the boundary between any of the Neighbourhood Emergency Units (see Emergency Base Map in Section 2). Criteria for allowing entry into closed areas will be established for each incident.

- **No Access** - General public prohibited from entering the area. Authorized personnel (emergency personnel) can access on a limited basis. Media representatives allowed access on a controlled basis.
- **Limited Access** – Some persons allowed into closed areas in accordance with criteria established by Incident Commander. Criteria should specify who can enter, for what purpose, time period, communication link.

RCMP is responsible for access control points, but experienced personnel from Ministry of Transportation and Infrastructure and Interior Roads Ltd can also help staff the control points. People working at access control points are to be equipped with hi-vis gear and radio communication.

#### **4.7 Securing Property**

Property security needs to be ensured during forced evacuations. This is done by limiting access and by continuous, or periodic, surveillance by designated security personnel (see Roles and Responsibility in section 3).

To aid emergency personnel and security patrols, evacuated buildings/properties should be marked using colored flagging tape stretched across entrances.

#### **4.8 Tracking Evacuees**

Evacuees need to be instructed to register with the Reception Centres (or EOC or Recovery Operations Centre if no RC available) so that emergency planners can track the number of evacuees and where to contact them for further instructions.

### **5 Livestock Evacuation**

Fire and flood are the main conceivable emergencies that would warrant evacuation of livestock, which can be found throughout the valley east of Thorsen creek. There are approximately 100 horses in the valley, which are kept in fenced in fields containing one to 10 horses. There are approximately ten farmers raising small herds of cattle (total about 200) and are mostly kept in fenced-in fields. Currently, there are no free range cattle. A few people keep pigs and sheep and there is one Llama farm. Chickens are kept by numerous people.

The availability of vehicles capable of transporting livestock is very limited. There are a few horse trailers available but it will take considerable co-ordination to effectively move horses and cattle on a large scale.

#### **5.1 General Livestock Evacuation Plan**

Given the poor availability of livestock transportation, the general plan is to only move livestock to the nearest safe field. In the worst circumstances, penned in animals can be set free to fend for themselves and be rounded up after danger has passed.

For Level 1, 2 or 3 evacuations the primary location to transport livestock to is the Rodeo grounds at Walker Island, as long as this site is not threatened. There are also a number of large, fenced fields scattered throughout the valley capable of keeping relatively large numbers of animals. Most farmers know which fields in their vicinity are suitable to

provide temporary pasture for their animals. Animals can be walked/jogged or herded to nearby fields or transported by vehicle if possible.

**Safe Field Options by Neighbourhood Emergency Unit:**

ID #	NEU	Safe Field Options
4	Snooka	<ul style="list-style-type: none"> <li>• Maurice Tuck's</li> <li>• Steve and Caitlin Thompson</li> </ul>
5	Snootli Stretch	<ul style="list-style-type: none"> <li>• Rodeo Grounds</li> <li>• Underhill's</li> </ul>
6	Snootli/ Klonic	<ul style="list-style-type: none"> <li>• West Coast Heli property</li> <li>• Ed Lynn Farms</li> <li>• Lorimer's</li> <li>• Jake Currie</li> <li>• Christina Hoppe</li> </ul>
7	Hagensborg	<ul style="list-style-type: none"> <li>• Rolling Pigeon Ranch</li> <li>• Troy Gurr</li> </ul>
8	Salloompt Turnoff	<ul style="list-style-type: none"> <li>• Pens?</li> </ul>
9	Salloompt	<ul style="list-style-type: none"> <li>• Turner's</li> <li>• Sheppard's</li> </ul>
10	Smith Subdivision	<ul style="list-style-type: none"> <li>• Some small pens</li> </ul>
11	East Nusatsum	<ul style="list-style-type: none"> <li>• ?</li> </ul>
12	Glacier View	<ul style="list-style-type: none"> <li>• ?</li> </ul>
13	Firvale	<ul style="list-style-type: none"> <li>• Numerous fields</li> </ul>
14	Upper Firvale	<ul style="list-style-type: none"> <li>• Floyd Mecham's</li> </ul>
15	Stuie	<ul style="list-style-type: none"> <li>• Tweedsmuir pens</li> </ul>

**5.2 Special Provisions**

The Llama farm in Snootli-Klonic NEU can pose transportation challenges as there are approximately 5 llamas that would require transport to a location capable of holding these animals (high fence).

**5.3 Transport**

The contact and resource list contains a partial listing of available horse trailers and trucks capable of transporting livestock.

**5.4 Accommodation & Feeding**

The valley should have enough local resources to accommodate and feed livestock for a Level 1, 2 or 3 evacuation for a few weeks, but for longer periods or Level 4 evacuation feed would need to be transported in.

## **6 Shelter In Place Option**

In some cases, it may be better for people to remain in their homes and 'Shelter In Place', especially when other protection measures could put the population in higher danger. This option assumes that the shelter and surrounding land is stable and provides some insulation from the hazard. If this course of action is advised, it is extremely important that regular communication and information can be provided in case conditions change. It also assumes that critical infrastructure is not impacted. People also need to be prepared and have appropriate supplies.

### **6.1 Shelter In Place Instructions**

Depending on the emergency, specific shelter-in-place instructions will need to be provided to the affected population. For example, a toxic gas leak will require people to seal their homes to prevent gas from entering. Flooding will require people to turn off their electrical power and climb to higher ground and roof tops for heli rescue.

## **7 Appendices**

The following sample forms are provided:

- Public Information Messaging Template
- Evacuation Alert
- Evacuation Order
- Evacuation Rescind
- Evacuation Planning Checklist
- Evacuation Travel Permit

## 7.1 Public Information Messaging Template

### PUBLIC INFORMATION MESSAGING TEMPLATE

This is \_\_\_\_\_  
*Rank/Title* \_\_\_\_\_ *Name*

from the \_\_\_\_\_  
*Agency/Department*

A \_\_\_\_\_  
*size/intensity* \_\_\_\_\_ *incident*

\_\_\_\_\_ *has occurred/is occurring* \_\_\_\_\_ *in* \_\_\_\_\_ *location*

Because of the potential danger to life and health \_\_\_\_\_  
*the authority*

\_\_\_\_\_ *has/have* \_\_\_\_\_ *ordered/recommended* \_\_\_\_\_ *#* \_\_\_\_\_ *blocks/kilometres/metres*

of that area to \_\_\_\_\_  
*evacuate shelter-in-place* \_\_\_\_\_ *immediately/as soon as possible*

If you are in following areas, you \_\_\_\_\_  
*must/should* \_\_\_\_\_ *leave the area/get inside a building*

This message will be repeated. Specific instructions and locations will be given

If you are in the following areas, you \_\_\_\_\_  
*must/should* \_\_\_\_\_ *leave the area/get inside a building*

\_\_\_\_\_ *immediately/as soon as possible*. The areas involved are as follows:

_____ <i>North/South/East/West</i>	_____ <i>Location: street, highway or other significant geographical point</i>
_____ <i>North/South/East/West</i>	_____ <i>Location: street, highway or other significant geographical point</i>
_____ <i>North/South/East/West</i>	_____ <i>Location: street, highway or other significant geographical point</i>
_____ <i>North/South/East/West</i>	_____ <i>Location: street, highway or other significant geographical point</i>

## 7.2 Evacuation Alert Template

### EVACUATION ALERT (DATE AND TIME)

An Evacuation Alert has been issued by (local authority) at the Emergency Operations Centre (EOC).

(Briefly describe event and potential risk) Because of the potential danger to life and health, the (local authority) has issued an Evacuation Alert for the following areas:  
Geographic description including boundaries and properties potentially impacted.

An Evacuation Alert has been issued to prepare you to evacuate your premises or property should it be found necessary.

Residents will be given as much advance notice as possible prior to evacuation; however you may receive limited notice due to changing conditions.

Provide map or description of potential evacuation route and map of evacuation alert area.

### WHAT YOU SHOULD DO WHEN AN ALERT IS IN EFFECT

Upon notification of an **ALERT**, you should be prepared for the evacuation order by:

- Locating all family members or co-workers and designate a Reception Centre outside the evacuation area, should an evacuation be called while separated.
- Gathering essential items such as medications, eyeglasses, valuable papers (i.e. insurance), immediate care needs for dependants and, if you choose, keepsakes (photographs, etc). Have these items readily available for quick departure.
- Preparing to move any disabled persons and/or children.
- Moving pets and livestock to a safe area.
- Arranging to transport your household members or co-workers in the event of an evacuation order. If you need transportation assistance from the area please call (contact number).
- Arranging accommodation for your family if possible.
- In the event of an evacuation, Reception Centres will be opened if required.
  - Monitor news sources for information on evacuation orders and locations of Reception Centres.

Further information will be issued at (insert time or meeting location) or should the situation change (or visit local authority website at).

For more information contact: (Local Authority Contact- Potentially Call Centre).

(Signature of Board/Chair or Designate, Mayor or Designate).

(Name of Local Authority).

**Note: A State of Emergency does not need to be declared to issue an Evacuation Alert.**

### 7.3 Evacuation Order Template

#### EVACUATION ORDER ISSUED (DATE AND TIME)

Pursuant to (cite legal authority) an Evacuation Order has been issued by (local authority) due to immediate danger to **life safety** due to (briefly describe event). Members of the (local police department and other applicable agencies) will be expediting this action.

The Evacuation Order is in effect for the following areas:

Geographic description including boundaries and properties impacted.

Include map of evacuation area and evacuation route.

#### WHAT YOU SHOULD DO:

You must leave the area **immediately**

Follow the travel route provided and register at (ESS Reception Centre address and name of facility).

If you need transportation assistance from the area please advise the individual providing this notice or call (contact number).

Close all windows and doors

Shut off all gas and electrical appliances, other than refrigerators and freezers

Close gates (latch) but do not lock

Gather your family: take a neighbour or someone who needs help

Take critical items (medicine, purse, wallet, and Keys) only if they are immediately available. Take pets in pet kennels or on leash.

Do not use more vehicles than you have to.

Do not use the telephone unless you need emergency service.

#### YOU MUST LEAVE THE AREA IMMEDIATELY

For more information contact: (Local Authority Contact- Potentially Call Centre).

(Signature of Board/Chair or Designate, Mayor or Designate).

(Name of Local Authority).

**A State of Emergency must be declared prior to issuing an Evacuation Order.**

## 7.4 Evacuation Rescind Template

### EVACUATION RESCIND (DATE AND TIME)

The Evacuation Order, pursuant to  (cite authority and legislation)  issued  (date and time)  to the area(s)  (geographic locations(s))  is rescinded.  (indicate if Evacuation Alert is in place) .

An Evacuation Order may need to be reissued: however if that is deemed necessary the process will re-commence.

For more information contact:  (Local Authority Contact – Potentially Call Centre) .

(Signature of Board/Chair or Designate, Mayor or Designate) .

(Name of Local Authority) .



## 7.5 Evacuation Plan Checklist

### Options

1. Do nothing
2. Determine potential threat area (emergency/disaster zone)/ stakeholders and establish a perimeter excluding people from entering the threat area by diverting vehicle and pedestrian traffic—indicate boundary on map

Agency in charge \_\_\_\_\_

Resources assigned

- Police change bullets from boxes
- Fire
- Public Works
- Other

3. Rescue – indicate area on map

Agency in charge \_\_\_\_\_

Resources Assigned

- HazMat Teams (special equipment needed)
- Fire Department (level of Personal Protective Equipment needed)
- Decontamination (set up area)
- Ambulance Service (triage and treatment area)
- Other

4. Evacuate – indicate area on map

Agency in charge \_\_\_\_\_

Resources Assigned

- HazMat Teams (special equipment needed)
- Fire Department (level of Personal Protective Equipment needed)
- Decontamination (set up area)
- Ambulance Service (triage and treatment area)

- Police (limits of involvement shown on map)
- Other
- Ensure all agencies consult prior to evacuation. Ensure that all agencies fully understand the decision.
- Consider reception area locations and the number of people who will need to be assisted.

Agency in charge \_\_\_\_\_

Resources Assigned

- Schools, recreation centres, other assembly halls.
- A site with adult-sized furniture, capability of feeding, and public address system.
- Choose a facility that will not be exposed if the wind shifts or increases, to create a more protective environment for possible HazMat incidents
- Alert the Emergency Operations Centre (EOC) for operations.
- Consider special facility/special population evacuation needs and establish priorities.
- Consider potential for domestic animals to be evacuated with families and alert S.P.C.A.
- Consider resources needed to conduct Emergency Evacuation Operations and advise potential mutual aid agencies.
- Determine the number of people needing transportation assistance.
- Dispatch transportation to special facilities and identified areas where assistance is required.

Agency in charge \_\_\_\_\_

Resources Assigned

- Transit (level of Personal Protective Equipment needed)
- Fire Department (level of Personal Protective Equipment needed)
- Decontamination (set up area)
- Ambulance service (triage and treatment area)
- Establish a policy on whether persons will be advised or ordered to evacuate.
- Prepare, print and distribute Emergency Evacuation notices if time permits.
- Assemble, brief and deploy Emergency Evacuation personnel.
- Announce Evacuation Plan decisions (boundaries and evacuation routes).

- Announce emergency reception area locations.
- Establish and announce a telephone number of evacuees to call for progress reports and re-entry times.
- Begin with Emergency Evacuation.
- Track numbers of evacuees and any reported injuries.
- Keep all field units updated regarding changes.
- Document the decision process.
- Notify local elected officials and the Provincial Emergency Program Regional Office.
- Appoint an Information Officer, with support and back up.
- Re-evaluate the BCERMS structure. Is a Logistics, Planning, or Finance Section needed, if not already appointed?
- Consider the need for a Crisis Intervention Team.
- Track all costs related to the incident.
- Keep evacuees at the reception facilities and group lodgings informed of incident progress and projected return times.
- Decide on allowing return into evacuated area in consultation with all relevant parties.
- Schedule a debriefing with all parties to evaluate the Evacuation Plan.
- Make suggested changes in this procedure to the Emergency Program Coordinator and the Emergency Policy Group.

### **5. Shelter-in-Place (include the following in the evacuation plan)**

Agency in charge \_\_\_\_\_

- Discuss and decide on appropriate alternate strategies.
- Seal off the area.
- Selective or partial evacuation.
- Issue a recommendation to close windows and shut off heating and ventilating systems in the threat area.
- Issue a recommendation for people to stay indoors.
- Appoint an Information Officer, with support and back up.
- Establish and announce a telephone number for persons to call for information on the incident.
- Re-evaluate the BCERMS structure. Is a Logistics, Planning or Finance Section needed, if not already appointed.

- Prepare, print and distribute incident information for persons in the affected area.
- Notify local elected officials and the Provincial Emergency Program Regional Office.
- Assemble and brief a standby force of personnel to assist with an emergency evacuation if the need arises.
- Establish and announce needed information to the public.
- Consider the need for a crisis intervention team.
- Continue to monitor the situation and to re-evaluate the need to evacuate, keeping all field units up to date regarding changes.
- Track all costs related to the incident.
- Keep residents informed of incident progress and projected time until the incident is over.
- Monitor the HazMat release and revise projected end of incident times.
- Consider changing tactics on consultation with all relevant parties.
- Provide advice and information on any special precautions that should be taken during and after the event.

## 7.6 Evacuation Access and Travel Permits



File: EOC

Permit No.: \_\_\_\_\_

Date of Issue:

\_\_\_\_\_

Valid from \_\_\_\_\_

to \_\_\_\_\_

This permit gives

\_\_\_\_\_

(name)

the permission to travel to/from Bella  
Coola to provide essential services.

Authorized by:

\_\_\_\_\_

**Applicant Waiver and Agreement  
(Release and Indemnity – Please  
Read Carefully)**

"I understand that I have voluntarily chosen to enter into an area that is under an evacuation order due to extreme and imminent hazards and as such, I accept complete responsibility and liability for my actions and choices. In consideration for being permitted to pass through the evacuation area, I hereby release and forever discharge the Central Coast Regional District and other responding agencies and their officers, agents, employees, contactors and volunteers (collectively, the "Released Parties") and agree to indemnify and save harmless the Released Parties from and against all losses, claims, damages, actions, causes of action, costs and expenses whatsoever, that the Released Parties may sustain, incur, suffer or be put to, including those arising from the negligence of the Released Parties, by reason of this permit or my entering into the evacuation area."

Name: (print)

\_\_\_\_\_

Signature: (sign)

\_\_\_\_\_

Ph: 250-799-5291 Fx: 250-799-5750

ccrd-bc.ca

626 Cliff St., Box 186  
Bella Coola, British Columbia  
V0T 1C0



# PASS THROUGH PERMIT

File: EOC

Permit No.: \_\_\_\_\_

Date of Issue: \_\_\_\_\_

Estimated Date/Time of passage through:

\_\_\_\_\_

The holder of this letter, as named below,  
is authorized for passage through the

\_\_\_\_\_

evacuation area, as their destination lies  
outside of the evacuation area.

Name: \_\_\_\_\_

DL #: \_\_\_\_\_

Destination Address: \_\_\_\_\_

Authorized by:

\_\_\_\_\_

**Applicant Waiver and Agreement  
(Release and Indemnity – Please  
Read Carefully)**

"I understand that I have voluntarily chosen to enter into an area that is under an evacuation order due to extreme and imminent hazards and as such, I accept complete responsibility and liability for my actions and choices. In consideration for being permitted to pass through the evacuation area, I hereby release and forever discharge the Central Coast Regional District and other responding agencies and their officers, agents, employees, contactors and volunteers (collectively, the "Released Parties") and agree to indemnify and save harmless the Released Parties from and against all losses, claims, damages, actions, causes of action, costs and expenses whatsoever, that the Released Parties may sustain, incur, suffer or be put to, including those arising from the negligence of the Released Parties, by reason of this permit or my entering into the evacuation area."

Name: (print)

\_\_\_\_\_

Signature: (sign)

\_\_\_\_\_

Ph: 250-799-5291 Fx: 250-799-5750

ccrd-bc.ca

626 Cliff St., Box 186  
Bella Coola, British Columbia  
V0T 1C0

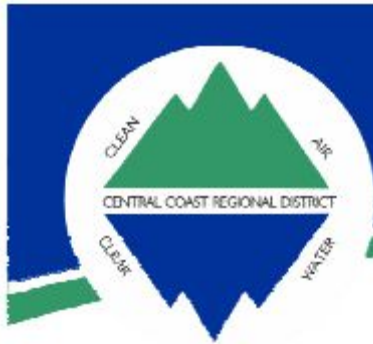

# RESIDENTIAL ADDRESS ACCESS PERMIT

File: EOC

Permit No.: \_\_\_\_\_

Date of Issue:

\_\_\_\_\_

Valid from \_\_\_\_\_

to \_\_\_\_\_

This permit gives

\_\_\_\_\_

(name)

the permission to travel to/from Bella  
Coola directly to their current residence  
at:

\_\_\_\_\_

Authorized by:

\_\_\_\_\_

**Applicant Waiver and Agreement  
(Release and Indemnity – Please  
Read Carefully)**

"I understand that I have voluntarily chosen to enter into an area that is under an evacuation order due to extreme and imminent hazards and as such, I accept complete responsibility and liability for my actions and choices. In consideration for being permitted to pass through the evacuation area, I hereby release and forever discharge the Central Coast Regional District and other responding agencies and their officers, agents, employees, contractors and volunteers (collectively, the "Released Parties") and agree to indemnify and save harmless the Released Parties from and against all losses, claims, damages, actions, causes of action, costs and expenses whatsoever, that the Released Parties may sustain, incur, suffer or be put to, including those arising from the negligence of the Released Parties, by reason of this permit or my entering into the evacuation area."

Name: (print)

\_\_\_\_\_

Signature: (sign)

\_\_\_\_\_

Ph: 250-799-5291 Fx: 250-799-5750

[ccrd-bc.ca](http://ccrd-bc.ca)

626 Cliff St., Box 186  
Bella Coola, British Columbia  
V0T 1C0

## **7.7 Evacuation Operations Guidelines (EMBC, 2009)**

Copy contained in CCRD EMP – Annex D – EMBC Supporting Emergency Manuals